

Att: Chris

8161 Rocky Fork Rd.

TENNESSEE DEPARTMENT OF ENVIRONMENT AND CONSERVATION  
APPLICATION FOR GROUND WATER PROTECTION SERVICES

Return to 898-7893

## 1. SERVICE REQUESTED: (check service)

- ☐ Septic System Construction Permit  
☐ Dwelling  
☐ Commercial: gpd  
☒ System Modification  
☒ Repair  
☐ Inspection Letter  
☐ Water Sample  
☐ Total Coliform  
☐ Fecal Coliform  
☐ Alternative Systems Permit  
☐ Large Conventional System Plan Review  
☐ Large Alternative System Plan Review  
☐ Experimental System Plan Review  
☐ Subdivision Evaluation: Lots:  
☐ Soil Mapping: Type \_\_\_\_\_ Acres \_\_\_\_\_  
☐ Installer Permit: Type(s) \_\_\_\_\_  
☐ Pumper Permit  
☐ Plot Approval - Individual Lot  
☐ Domestic Septage Disposal Site Permit

APPLICANT  
COMPLETE QUESTIONS:

FEES DUE

PTBMS CODES  
Code Supp/C

		78064	
		73064	
		78064	
		78032	
		78030	
		78036	Y
		78038	Y
		78068	
		78090	
		78090	
		78072	
		78084	
			Y
		78026	Y
		78028	
		78029	
		78031	

\*Applicant may review these service requests with Environmental Specialist prior to processing application.

## 2. LANDOWNER:

Names: Christopher S. Stinson  
Address: 8161 Rocky Fork Rd.  
Day Phone: 615-476-8851

## APPLICANT:

Name: Christopher S. Stinson  
Address: 8161 Rocky Fork Rd.  
Day Phone: 615-476-8851

## ORIGINAL OWNER

Name: see attached

## 3. LOCATION OF LOT OR SITE: a) In a subdivision?

b) Non-Subdivision: ☒ Give specific directions and address to the lot or site: see attached

Lot #

## 4. FOR SEPS PERMIT ONLY: a) Size of lot

b) Number of Bedrooms

c) How many occupants?

d) Excavated Basement? Yes No

e) Basement Plumbing Fixtures? Yes No

f) Amount of water used monthly (gallons)

g) Water Supply: Public Well Spring

h) Is the lot staked? If not, date it will be staked:

Is the house staked? If not, date it will be staked:

i) Installer, if known:

MAP PARCEL

51

36.06

## 5. FOR INSPECTION LETTER ONLY: Will pick up Please mail

a) Age of house b) Is house vacant? How long?

c) Original sewage system inspected

d) Date of previous repairs Inspected

e) Is waste water "backing up" into plumbing fixtures? Surfacing on the ground?

f) All waste water including washing machines routed into septic tank

## 6. FOR WATER SAMPLE ONLY: a) Source of Supply: Spring Well

b) Is there an outside faucet? c) Is the source chlorinated?

d) For Wells: Is the casing 6" above the ground? Is a sanitary seal on the casing?

## 7. MAKE A ROUGH SKETCH ON BACK OF THIS WHITE PAGE SHOWING DIRECTIONS TO PROPERTY, PROPERTY LINES, HOUSE SITE, WELL LOCATION, SPRING LOCATION, PLANNED DRIVEWAY AND UTILITIES.

## 8. ALL FEES DUE IN ADVANCE AND ARE NON-REFUNDABLE (except upon appeal). See Fee Schedule on reverse. Make check payable to: TREASURER, STATE OF TENNESSEE

## 9. I certify that the above information is true and correct to the best of my knowledge, and that I have been authorized by the above named landowner to submit this Application for Environmental Services to the Division of Ground Water Protection.

DATE: 3-12-07

SIGNATURE: Chris Stinson

AMOUNT PAID: \$

RECEIPT NUMBER

39660

White: File Canary: Owner

Please describe problem

**TENNESSEE DEPARTMENT OF ENVIRONMENT AND CONSERVATION  
DIVISION OF GROUND WATER PROTECTION  
PERMIT FOR CONSTRUCTION OF SUBSURFACE SEWAGE DISPOSAL SYSTEM**

Issued to: <u>Christopher Stinson</u> <small>Owner, Developer, Contractor/Installer, Etc.</small> Location: <u>8161 Rocky Fork Road</u> <u>Map 51 Parcel 36.06</u> Installation: <input type="checkbox"/> 1. New Installation <input checked="" type="checkbox"/> 2. Repair to Existing System Establishment: <input type="checkbox"/> 1. Residential: # Bedrooms _____ <input type="checkbox"/> 2. Other: _____ (specify) Gal/Day _____	Evaluation Based Upon: <input type="checkbox"/> 1. Soil typing by Soil Scientist <input type="checkbox"/> a. General <input type="checkbox"/> b. High Intensity <input type="checkbox"/> c. Extra High Intensity <input type="checkbox"/> 2. Soil Percolation Test <input type="checkbox"/> 3. Environmental Specialist Estimated Absorption Rate: _____ MPI Approval based upon: Statute No. <u>T.C.A. 68-221-403</u> <input type="checkbox"/> (c) Percolation test <input type="checkbox"/> (d) Grandfather clause, Current standards except those specified <input type="checkbox"/> (f) 12" (karst) and 6" (non-karst) buffer required	Type of System: <input checked="" type="checkbox"/> 1. Conventional <input type="checkbox"/> 2. Low Pressure Pipe <input type="checkbox"/> 3. Mound <input type="checkbox"/> 4. Lagoon <input type="checkbox"/> 5. Large Diameter Graveless Pipe <input type="checkbox"/> a. Sand backfill required <input type="checkbox"/> 6. Other
--	--	--

This system shall consist of a two compartment septic tank holding Existing gallons, with \_\_\_\_\_ linear feet in \_\_\_\_\_ trenches, \_\_\_\_\_ inches wide and \_\_\_\_\_ inches deep. (Depth of gravel: \_\_\_\_\_ inches)

Also required:  
☐ 1. Soil Improvement Practice (SIP)  
☐ 2. Flow Diversion Valve  
☐ 3. Sewage Pump  
☐ 4. Other: \_\_\_\_\_

All installers of subsurface sewage disposal systems must hold a valid annual license from the Tennessee Department of Environment and Conservation.

The recipient of this permit agrees to construct or have constructed the above described system in accordance with T.C.A. 68-221-401 et. seq. and The Regulations To Govern Subsurface Sewage Disposal Systems. If any part of the system is covered before being inspected and approved, it shall be uncovered by the recipient of the permit at the direction of personnel of the Department of Environment and Conservation. Any cutting, filling or alterations of the soil conditions on the aforementioned property after this day may render this approval null and void.

☒ Chris Stinson \_\_\_\_\_ Date 4/18/07  
(Signature of Recipient)  
 Issued at Murfreesboro \_\_\_\_\_ Tennessee, in Rutherford County  
 By John F Walker \_\_\_\_\_ Date April 18, 2007  
(Name and Title) (Date of Issue)

This permit is valid for 3 years from date of issue.

Notes	<u>Check tight line for the 85 feet from end of 3-30-07</u> <u>repair to driveway</u> <u>If line under driveway is clear, smaller (3 inch) Sch. 40</u> <u>PVC may be used under driveway</u>

X Crossover  
 --- SIP  
 --- Field Line  
 --- Solid Line

This is a permit to construct and is not intended to imply approval of any work proposed or completed on this lot.



**TENNESSEE DEPARTMENT OF ENVIRONMENT AND CONSERVATION  
DIVISION OF GROUND WATER PROTECTION  
PERMIT FOR CONSTRUCTION OF SUBSURFACE SEWAGE DISPOSAL SYSTEM**

Issued to: <u>Christopher Stinson</u> <small>Owner, Developer, Contractor, Installer, Etc.</small> Location: <u>8161 Baby Fork Road</u>  Installation: <input type="checkbox"/> 1. New Installation <input checked="" type="checkbox"/> 2. Repair to Existing System Establishment: <input type="checkbox"/> 1. Residential: # Bedrooms _____ <input type="checkbox"/> 2. Other: _____ (specify) Gal/Day _____	Evaluation Based Upon: <input type="checkbox"/> 1. Soil typing by Soil Scientist <input type="checkbox"/> a. General <input type="checkbox"/> b. High Intensity <input type="checkbox"/> c. Extra High Intensity <input type="checkbox"/> 2. Soil Percolation Test <input type="checkbox"/> 3. Environmental Specialist Estimated Absorption Rate: _____ MPI  Approval based upon: Statute No. <u>T.C.A. 68-221-403</u> <input type="checkbox"/> (c) Percolation test <input type="checkbox"/> (d) Grandfather clause. Current standards except those specified <input type="checkbox"/> (f) 12" (karst) and 6" (non-karst) buffer required  <input checked="" type="checkbox"/> (i) 9" buffer required (24"-36" total soil depth) <input type="checkbox"/> (k) Grandfather clause — meets June 30, 1990 standards (repair only) <input type="checkbox"/> Other _____	Type of System: <input checked="" type="checkbox"/> 1. Conventional <input type="checkbox"/> 2. Low Pressure Pipe <input type="checkbox"/> 3. Mound <input type="checkbox"/> 4. Lagoon <input type="checkbox"/> 5. Large Diameter Graveless Pipe <input type="checkbox"/> a. Sand backfill required <input type="checkbox"/> 6. Other _____
--	--	--

This system shall consist of a two compartment septic tank holding Existing gallons, with \_\_\_\_\_ linear feet in \_\_\_\_\_ trenches, \_\_\_\_\_ inches wide and \_\_\_\_\_ inches deep. (Depth of gravel: \_\_\_\_\_ inches)

Also required:  
☐ 1. Soil Improvement Practice (SIP)  
☐ 2. Flow Diversion Valve  
☐ 3. Sewage Pump  
☐ 4. Other: \_\_\_\_\_

All installers of subsurface sewage disposal systems must hold a valid annual license from the Tennessee Department of Environment and Conservation.

The recipient of this permit agrees to construct or have constructed the above described system in accordance with T.C.A. 68-221-401 et. seq. and The Regulations To Govern Subsurface Sewage Disposal Systems. If any part of the system is covered before being inspected and approved, it shall be uncovered by the recipient of the permit at the direction of personnel of the Department of Environment and Conservation. Any cutting, filling or alterations of the soil conditions on the aforementioned property after this day may render this approval null and void.

By <u>John F Walber</u> 898-7292 <small>(Name and Title)</small>	Date <u>3-13-07</u> <small>(Date of Issue)</small>
Issued at <u>Murfreesboro</u> <small>(Signature of Recipient)</small>	Tennessee, in <u>Rutherford</u> County

This permit is valid for 3 years from date of issue.

Notes <u>Check outlet Tee Replace if not functional</u> <u>Tight line may need replacing</u> <u>Upper end of tight line above</u> <u>drive way may be replaced</u> <u>without re-doing lower end</u> <u>of line if more</u>	
---	--

X Crossover  
 - - - Field Line  
 \_\_\_\_\_ Solid Line

This is a permit to construct and is not intended to imply approval of any work proposed or completed on this lot.





# CERTIFICATE OF COMPLETION OF SUBSURFACE SEWAGE DISPOSAL SYSTEM

Issued to:

Christopher Stinson

Owner/Developer/Contractor/Installer, Etc.

Location

8161 Rocky Fork Road

51

36.06

Type of system

- ☒ 1. Conventional  
☐ 2. Low Pressure Pipe  
☐ 3. Mound  
☐ 4. Lagoon  
☐ 5. Large Diameter Gravelless Pipe  
     (a) Sand backfill required Yes ( ) No ( )  
☐ 6. Other \_\_\_\_\_

(type)

(volume)

Septic Tank

Estimated Absorption Rate \_\_\_\_\_

(minutes per inch)

( ) New Installation

☒ Repair

( ) Other

Installed by:

Ralph Darnell

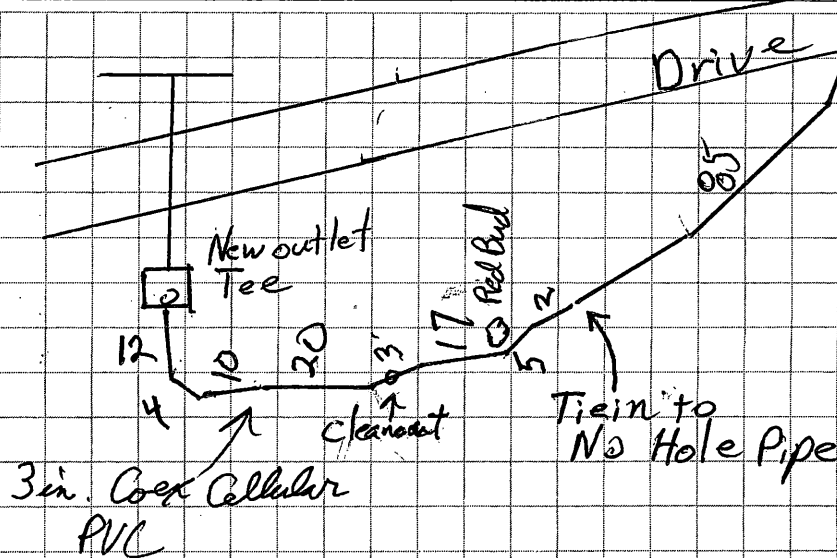

Construction Approved By:

John F. Walker

(Name and Title)

March 30, 2007

(date)





# CERTIFICATE OF COMPLETION OF SUBSURFACE SEWAGE DISPOSAL SYSTEM

Issued to: Christopher Stevenson  
Owner, Developer, Contractor, Installer, Etc.  
 Location: 8161 Rocky Fork Road  
Map 51 Parcel 36.06

Type of system  
☒ 1. Conventional  
☐ 2. Low Pressure Pipe  
☐ 3. Mound  
☐ 4. Lagoon  
☐ 5. Large Diameter Gravelless Pipe  
     (a) Sand backfill required Yes ( ) No ( )  
☐ 6. Other \_\_\_\_\_  
 \_\_\_\_\_ Septic Tank  
 (type) (volume)  
 Estimated Absorption Rate \_\_\_\_\_ (minutes per inch)  
☐ New Installation ☒ Repair ☐ Other  
 Installed by: St & S Under ground

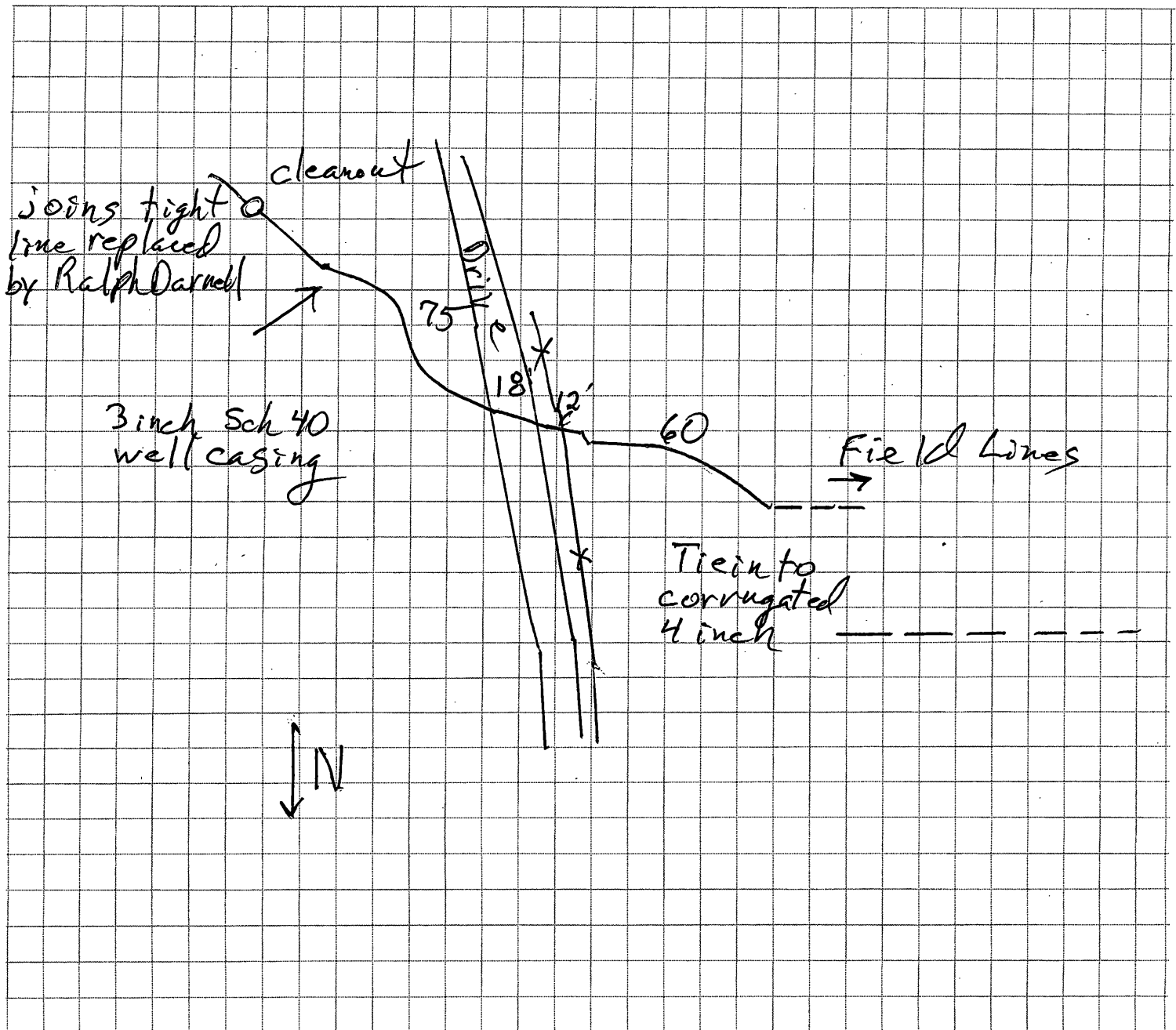

Construction Approved By: \_\_\_\_\_

John F. Walker  
 (Name and Title)

May 18, 2007  
 (Date)

## ADDENDUM

LAND in the 4th Civil District of Rutherford County, Tennessee, being apart of the property conveyed to Charles C. Bonds and wife, Rachel Yates Bonds by deed recorded in Book 218, page 86, Register's Office for Rutherford County, Tennessee, described as follows:

BEGINNING at a point in the center of Rocky Fork Road 117 feet East of Cook Lane; thence along the center of said Road North 75 degrees 00 minutes East for 85.00 feet to a point; thence North 79 degrees 35 minutes East for 100 feet to a point; thence North 88 degrees 50 minutes East for 100.00 feet; thence North 87 degrees 05 minutes East for 100 feet; thence East 73.50 feet; thence leaving said Road, South 38 degrees 30 minutes East for 187.63 feet; thence South 18 degrees 00 minutes East for 280.00 feet to an iron pin in fence; thence South 73 degrees 31 minutes West 326.00 feet to an iron pin; thence North 59 degrees 43 minutes West for 160.00 feet; thence North 23 degrees 13 minutes West for 440.00 feet to the point of beginning, containing 5 acres plus.

RECORDING FEE 12.00  
 STATE TAX 203.50  
 REGISTER'S FEE 1.00  
 TOTAL PAID 216.50  
 RECEIPT NO. 73848

I, Sam Yeargan, Register of Rutherford County, do certify that the foregoing instrument is registered in said office in book 497 page 448 that it was received 2-20-12 1912 at 8:41 o'clock P. M. and entered in notebook 52 page 212 Sam Yeargan, Register, Deputy

451

★ - As for the original owners of the Property this is all I could find.

Pg. 1